



---

## NON-FARM USE CANNABIS PRODUCTION FACILITIES IN THE ALR

---

*Is a Policy Needed?*

### CPF

---

- CPF = cannabis production facility
  - › growing, rearing, harvesting, storing, processing, testing, shipping, R&D

## OUTLINE

---

- Non-farm Use application for CPFs
- Types of Buildings Being Proposed
- Opportunity for Policy
- Is a Policy Needed?
- Potential Policy Choices
  - › choose your own adventure

## BIG PICTURE: RESPONDING TO LEGALIZATION

---

- **Non-Farm Use in ALR** ——— **today**
- Retail Sales Policy ——— next year
- Zoning Amendments ——— next year
  - › medical marihuana → cannabis
  - › clarify retail sales
  - › improved zoning regulations

## ALR REGULATION

---

### ❑ Changed July 13, 2018

#### ❑ Before

- › Marihuana production was a Farm Use in ALR
- › Permitted without restriction on ALR land
- › Local gov't could not prohibit & had limited ability to regulate in ALR

#### ❑ Now

- › Cannabis production in ALR a Farm Use only if grown in:
  - Soil
  - Structure with soil base
  - Crop growing structure built or started before July 13/18

## ALR REGULATION

---

### ❑ Under the new ALR Reg...

- › CPFs in new buildings will be Non-Farm Uses in the ALR
  - require Non-Farm Use application to Local Gov't & ALC
  - Local Gov't can deny Non-Farm use applications
- › Local gov't has broader authority to prohibit and regulate CPFs within ALR

## TYPES OF CPF BUILDINGS PROPOSED

- 3 current Non-Farm Use application
  - › Farms Road, Area F
  - › Seux Road, Area F
  - › Dent Road, Area B
- CPFs in the works outside ALR
  - › e.g. Bell Rd(G) → not the subject here

### **PacWest Canopy**

Farms Rd,  
Area "F"

Footprint  
100,344 s.f.

Height  
40 ft.

2 storey

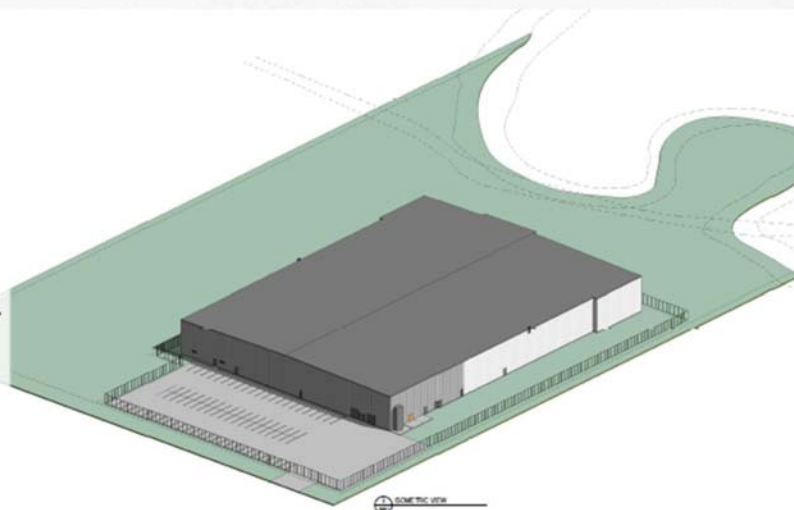

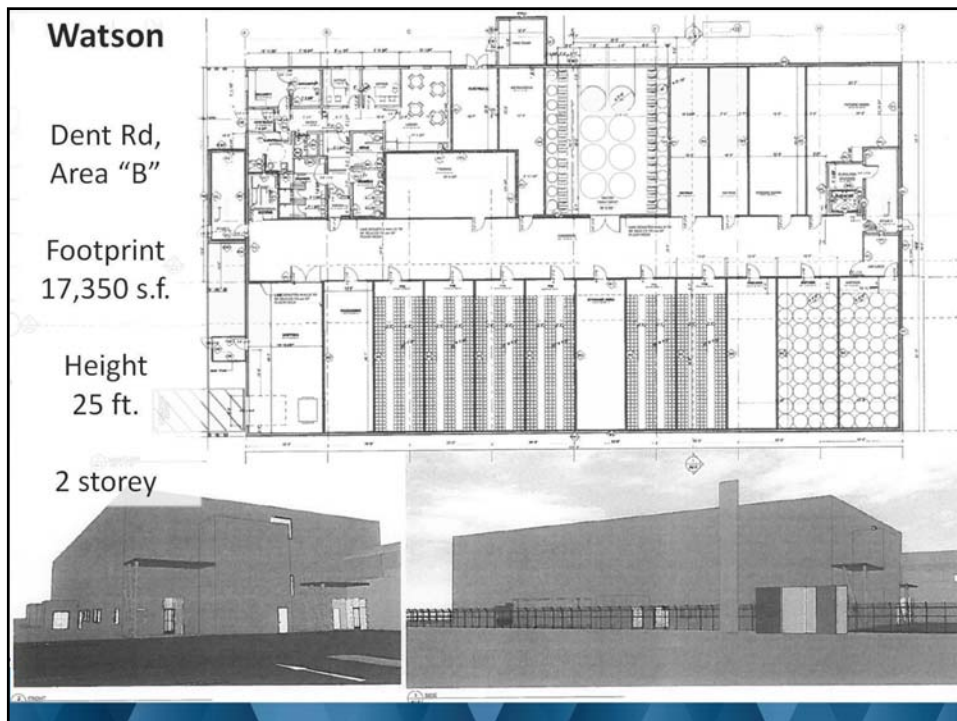
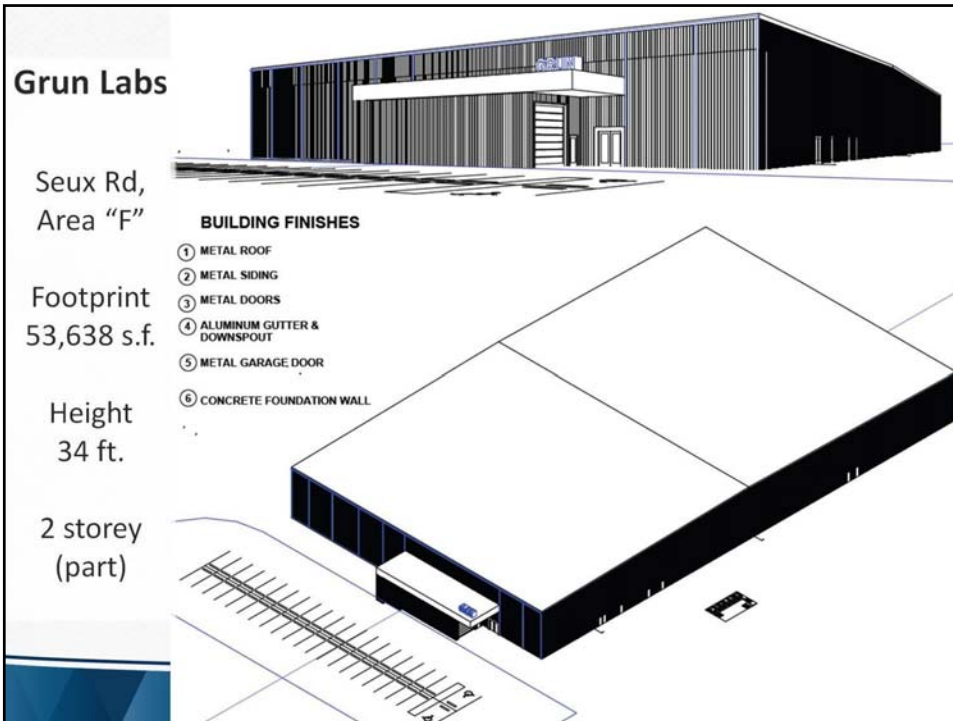



## BUILDING ELEMENTS

---

- ❑ Security fencing
    - › 3 m
    - › breach detection
  - ❑ Exterior lighting
  - ❑ Cameras & security
  - ❑ Ventilation
- Health  
Canada  
licencing  
requirements

## OPPORTUNITY FOR POLICY

---

- ❑ Decisions on Non-Farm Use applications are discretionary
  - › ALC will not consider application unless it is forwarded by resolution of the Board
- ❑ Policy could...
  - › reduce impacts to community
  - › provide industry with greater certainty
  - › stop gap until improved zoning regs are in place

## IS A POLICY NEEDED?

---

- Consideration:
  - › Large, industrial-style buildings in rural agricultural landscapes
  - › Community concerns (Area F) with:
    - light spill
    - odour
    - aesthetics
  - › Policy can help with these

## IS A POLICY NEEDED?

---

- Consideration:
  - › Growing in buildings (non-farm use) may have less impact than growing in soil or greenhouses (farm use)
    - buildings offer greater emissions control & security
    - don't want to disincentivize the option with less impacts

## IS A POLICY NEEDED?

---

- Consideration:
  - › Policy won't affect CPFs outside ALR
    - onerous policy may create an uneven playing field

## IS A POLICY NEEDED?

---

- Consideration:
  - › It's a permitted use
    - FVRD zoning allows Medical Marihuana Grow Operation in agricultural zones
    - but... zoning regs are basic
      - standard setbacks for agricultural buildings
      - developed before changes to ALR Regulation
      - don't address light, odour and other issues



PLEASE RAISE  
YOUR HAND  
TO INDICATE  
YOUR  
ANSWER TO  
THE  
QUESTIONS  
ON THE  
FOLLOWING  
SLIDES...

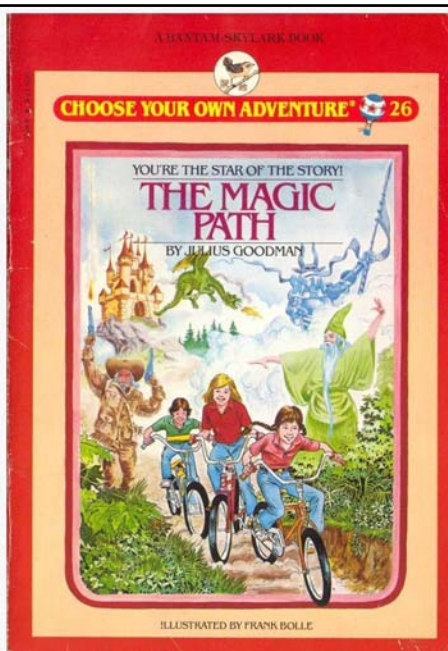

Is a policy needed to guide Non-Farm Use  
applications for CPFs in the ALR?

1. Yes
2. No
3. Don't know yet

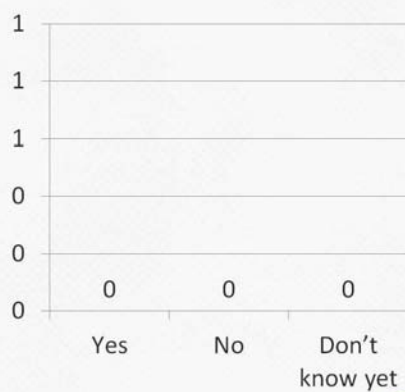

Should the policy require a public info meeting,  
where the Board deems it appropriate?

1. Yes
2. No
3. Don't know yet

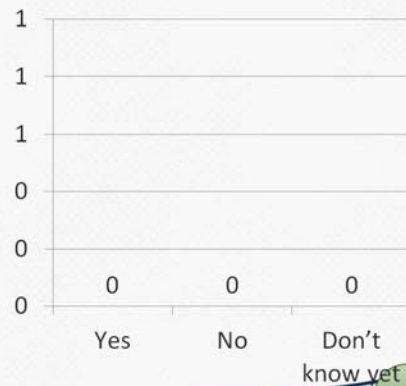

10

Should the policy address light spill to sky  
and/or neighbours?

1. Yes
2. No
3. Don't know yet

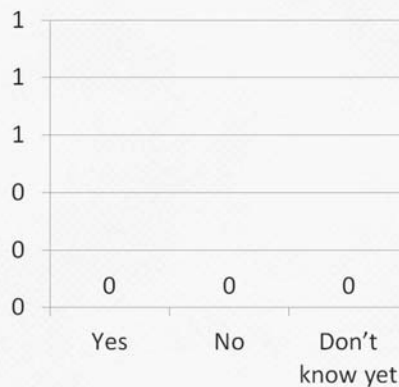

10

Should the policy require professional design of an odour control system for the building?

1. Yes
2. No
3. Don't know yet

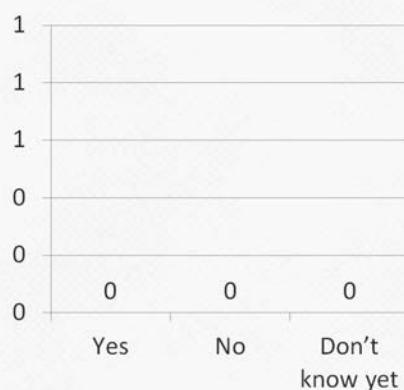

10

Should the policy address setback distances from lot lines, residential zones, schools, parks and other CPFs?

1. Yes
2. No
3. Don't know yet

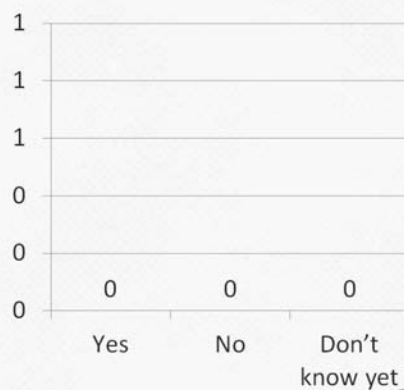

10

Should the policy support a covenant limiting the use of buildings to CPF and permitted Farm Uses?

1. Yes
2. No
3. Don't know yet

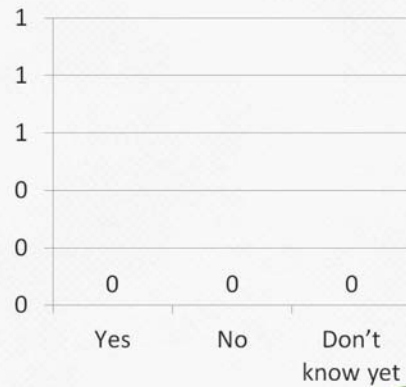

10

Should the policy require architectural design for screening and 'fit' with community?

1. Yes
2. No
3. Don't know yet

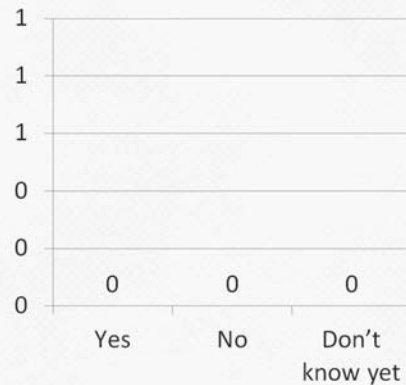

10

Just confirming... is a policy needed?

1. Yes
2. No
3. Don't know yet

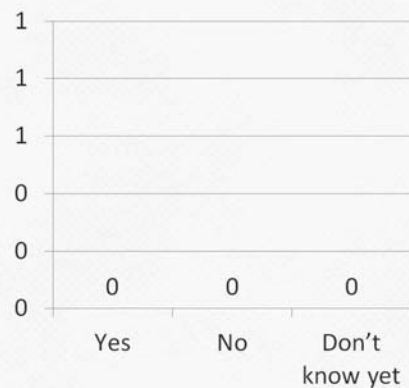

10

## THANK YOU!

- If you chose a policy...
  - › draft policy based on input for your consideration in January
  - › applications will be brought forward in conjunction with a policy
- If you chose no policy...
  - › we appreciate your time and guidance
  - › applications will brought forward independently