

December 9, 2019

Hello!

Most property owners are missing from Cultus Lake at this time of year. That said, we were able to get in touch with some of the home owners to discuss our request for bylaw variances.

Of those home owners who understand our variance application, 100% were supportive and were also surprised that these variances would not be granted as common sense. See the attached image of the map identifying the homes of home owners who support our variance requests. See the signed attached support letter. This represents 100% acceptance and support from 100% of the people we were able to speak to:

1. 153 1st Avenue – waterfront, two doors down from to 155 1st Avenue
2. 154 1st Avenue – waterfront, next door to 155 1st Avenue
3. 249 1st Avenue – across the street from to 155 1st Avenue
4. 250 1st Avenue – across the street from to 155 1st Avenue
5. 156 1st Avenue – waterfront, two doors down from to 155 1st Avenue
6. 157 1st Avenue – waterfront, three doors down from to 155 1st Avenue
7. 158 1st Avenue – waterfront, four doors down from to 155 1st Avenue
8. 162 1st Avenue – waterfront, two doors down from to 155 1st Avenue
9. 381 Cedar Street – intersecting , two doors down from to 155 1st Avenue

Thanks,

Gwyllyn S. Goddard

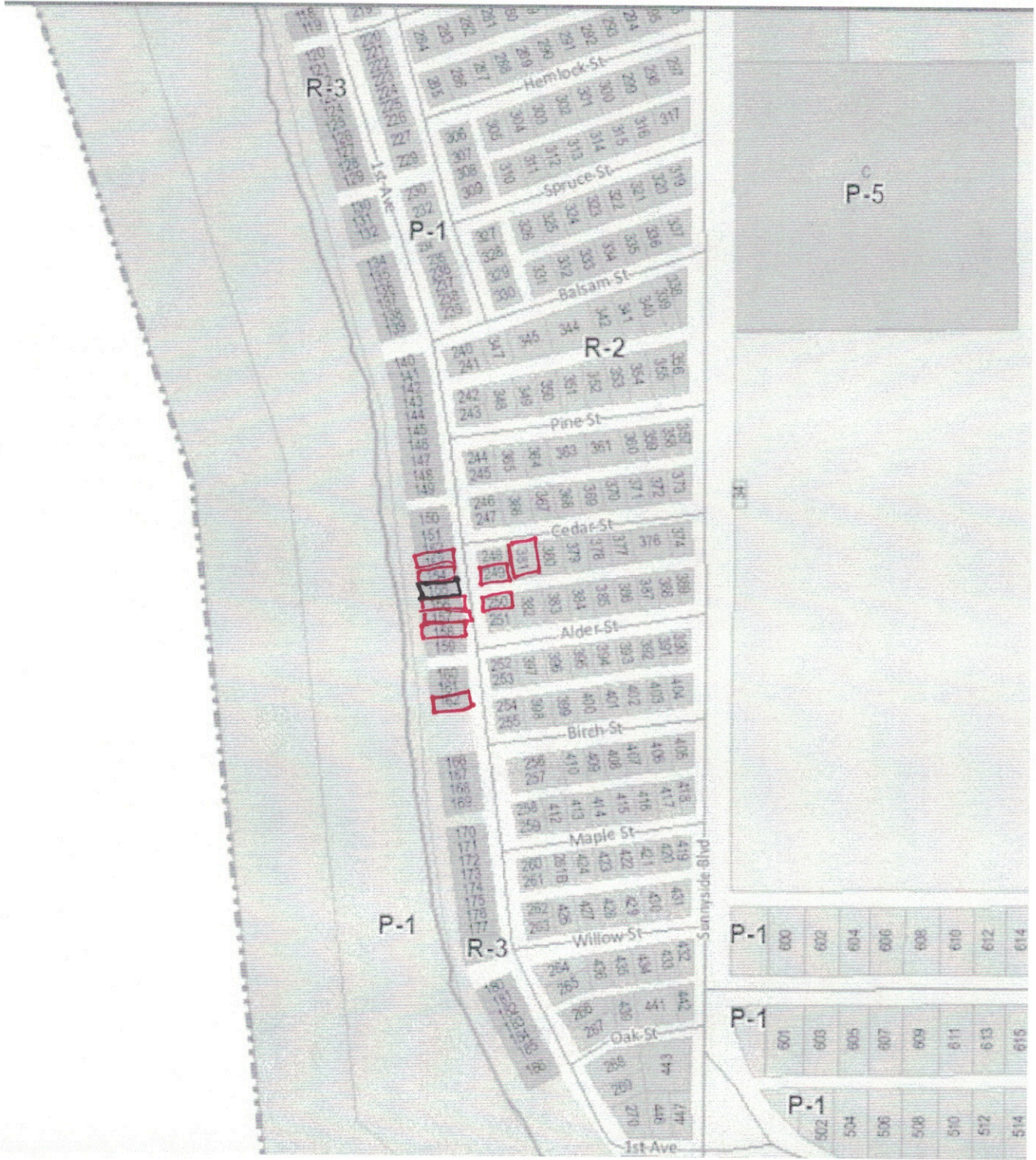

Goddard Family Home

Letter of Support - Neighbourhood Circulation

Signature Page

Full Name: BRIAN HUNTER

Home Address: 249 FIRST AVE CULTUS LAKE BC V2R 4Z2

- ☒ I fully support the proposed relaxations
☐ I support the proposed relaxations with conditions
☐ I do not agree with the proposed relaxations

Comments:

Signature: 

Thank you for your support, Neighbour!

Please call me if you have questions, comments, or concerns?

Goddard Family Home

Letter of Support - Neighbourhood Circulation

Signature Page

Full Name: IAN HUNTER

Home Address: 10840 SEAMOUNT RD RICHMOND V7A 4A6

Telephone Number _____

Email Address: _____

- ☒ I fully support the proposed relaxations
☐ I support the proposed relaxations with conditions
☐ I do not agree with the proposed relaxations

Comments: _____

➔ 250 1ST AVENUE

Signature: Ian Hunter

Thank you for your support, Neighbour!

Please call me if you have questions, comments, or concerns?

Goddard Family Home

Letter of Support - Neighbourhood Circulation

Signature Page

Full Name: GORDON CAMPBELL

Home Address: 162 FIRST AVENUE, CULTUS LAKE

Telephone Number: _____

Email Address: _____

- ☒ I fully support the proposed relaxations
☐ I support the proposed relaxations with conditions
☐ I do not agree with the proposed relaxations

Comments:

THE NEW PARKING REGULATIONS ARE
REDICULOUS. GOOD LUCK WITH YOUR VARIANCE.
I FULLY SUPPORT YOUR PROPOSAL

Signature: Gord Campbell

Thank you for your support, Neighbour!

Please call me if you have questions, comments, or concerns?

Goddard Family Home

Letter of Support - Neighbourhood Circulation

Signature Page

Full Name: Dereeth Campbell

Home Address: 162 First Ave, Cultus Lake

Telephone Number: _

Email Address: _____

- ☒ I fully support the proposed relaxations
☐ I support the proposed relaxations with conditions
☐ I do not agree with the proposed relaxations

Comments:

The new parking regulations make absolutely no sense. They need to be amended to support current off street parking as is currently happening (or has happened in the past).
Space is crucial here both for basements + parking. I support these 2 scenarios

Signature: Dereeth Campbell

Thank you for your support, Neighbour!

Please call me if you have questions, comments, or concerns?

Goddard Family Home

Letter of Support - Neighbourhood Circulation

Signature Page

Full Name: Kathalin Taylor

Home Address: 153 1st Ave Cultus Lake BC, V2R4Z2

Telephone Number:

Email Address:

- ☒ I fully support the proposed relaxations
☐ I support the proposed relaxations with conditions
☐ I do not agree with the proposed relaxations

Comments:

Looking forward to the project!

Signature: Kathalin Taylor

Thank you for your support, Neighbour!

Please call me if you have questions, comments, or concerns?

Goddard Family Home

Letter of Support - Neighbourhood Circulation

Signature Page

Full Name: LISA HENNAN

Home Address: 154 1ST AVE

Telephone Number: _____

Email Address: _____

- ☒ I fully support the proposed relaxations
☐ I support the proposed relaxations with conditions
☐ I do not agree with the proposed relaxations

Comments:

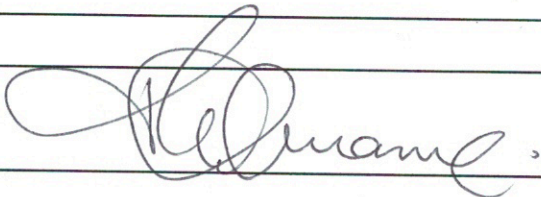
Signature: 

Thank you for your support, Neighbour!

Please call me if you have questions, comments, or concerns?

Goddard Family Home

Letter of Support - Neighbourhood Circulation

Signature Page

Full Name: D. RICHARD WENHAM

Home Address: 157 1st AVE.

Telephone Number: _

Email Address: _

- ☒ I fully support the proposed relaxations
☐ I support the proposed relaxations with conditions
☐ I do not agree with the proposed relaxations

Comments:

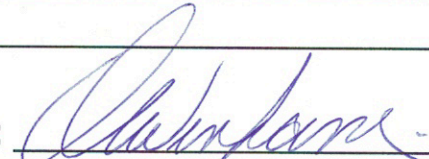
Signature: 
D. Richard Wenham

Thank you for your support, Neighbour!

Please call me if you have questions, comments, or concerns?

Goddard Family Home

Letter of Support - Neighbourhood Circulation

Signature Page

Full Name: Gary Baker

Home Address: 381 Cedar St., Cultus Lake

Telephone Number: _____

Email Address: _____

- ☒ I fully support the proposed relaxations
☐ I support the proposed relaxations with conditions
☐ I do not agree with the proposed relaxations

Comments:

Not related to the requested 'relaxations'!
A member of our household has asthma
and is very sensitive to smoke. The proposed
building appears to have a wood fireplace.
This we do not support. Please replace
with a gas fireplace!

Signature: Gary Baker

Thank you for your support, Neighbour!

Please call me if you have questions, comments, or concerns?

Goddard Family Home

Letter of Support - Neighbourhood Circulation

Signature Page

Full Name: Sheryl Henderson

Home Address: 381 Cedar St.; Cultus Lake

Telephone Number:

Email Address:

- ☒ I fully support the proposed relaxations
☐ I support the proposed relaxations with conditions
☐ I do not agree with the proposed relaxations

Comments:

I do support the proposed relaxations as requested by Gwynlyn Toddard. However, I do not support a wood burning fireplace, which is shown in his building plans. This would contribute to air pollution and affect those of us in the neighbourhood with respiratory problems. Moreover, it is my understanding that wood burning fireplaces are not allowed in new houses at Cultus Lake.

Signature: 
Nov. 30, 2019

Thank you for your support, Neighbour!

Please call me if you have questions, comments, or concerns?

Goddard Family Home

Letter of Support - Neighbourhood Circulation

Signature Page

Full Name: BRIAN E JEWEL PAULS

Home Address: 158 1ST AOE CACTUS LK.

Telephone Number:

Email Address:

- ☒ I fully support the proposed relaxations
☐ I support the proposed relaxations with conditions
☐ I do not agree with the proposed relaxations

Comments:

THE PROPOSED PLAN MAKES TOTAL SENSE.

Signature: 

Thank you for your support, Neighbour!

Please call me if you have questions, comments, or concerns?

Letter of Support - Neighbourhood Circulation

Full Name: Elma Pauls

Home Address: #156 - 1st Avenue, Cuthbert Lake
5395 Sunnys Prairie Rd, Chilliwack

Telephone Number: _____

Email Address: _____

- ☒ I fully support the proposed relaxations
- ☐ I support the proposed relaxations with conditions
- ☐ I do not agree with the proposed relaxations

Signature: E. Pauls

Thank you for your support, Neighbour!

Please call me if you have questions, comments, or concerns?