

**SCHEDULE A-4**

**Permit Application**

I / We hereby apply under Part 26 of the *Local Government Act* for a;

- ☒ Development Variance Permit
- ☐ Temporary Commercial / Industrial Permit
- ☐ Development Permit

An Application Fee in the amount of \$\_\_\_\_\_ as stipulated in FVRD Application Fees Bylaw No. 1231, 2013 must be paid upon submission of this application.

Civic Address 88-3942 Columbia Valley Rd PID \_\_\_\_\_

Legal Description Lot \_\_\_\_\_ Block \_\_\_\_\_ Section \_\_\_\_\_ Township \_\_\_\_\_ Range \_\_\_\_\_ Plan \_\_\_\_\_

*The property described above is the subject of this application and is referred to herein as the 'subject property.' This application is made with my full knowledge and consent. I declare that the information submitted in support of the application is true and correct in all respects.*

Owner's  
Declaration

Owner's  
Contact  
Information

Office Use Only	Date <u>JAN. 2, 2017</u>	File No. <u>3090-20 2018-02</u>
	Received By <u>5094/H</u>	Folio No. <u>733.74387.003</u>
	Receipt No. <u>5094/1</u>	Fees Paid: \$ <u>350.00</u>

Agent

I hereby give permission to Tim Burkholder to act as my/our agent in all matters relating to this application.

Only complete this section if the applicant is NOT the owner.

Agent's contact information and declaration

Name of Agent <u>Tim Burkholder</u>		Company	
Address		City	
Email		Postal Code	
Phone	Cell	Fax	

I declare that the information submitted in support of this application is true and correct in all respects.

Date

Jan 2, 18

#### Development Details

Property Size \_\_\_\_\_ Present Zoning \_\_\_\_\_

Existing Use \_\_\_\_\_

Proposed Development \_\_\_\_\_

Proposed Variation / Supplement Set back for unattached decks + Attached carports of non-combustible materials

(use separate sheet if necessary)

Reasons in Support of Application Pre existing current owner and difficult to modify.

**Riparian  
Areas  
Regulation**

Please indicate whether the development proposal involves residential, commercial, or including vegetation removal or alteration; soil disturbance; construction of buildings and structures; creation of impervious or semi-pervious surfaces; trails, roads, docks, wharves, bridges and, infrastructure and works of any kind – within:

yes ☐ no ☒

30 metres of the high water mark of any water body

yes ☐ no ☒

a ravine or within 30 metres of the top of a ravine bank

"Water body" includes; 1) a watercourse, whether it usually contains water or not; 2) a pond, lake, river, creek, or brook; 3) a ditch, spring, or wetland that is connected by surface flow to 1 or 2 above.

Under the *Riparian Areas Regulation* and the *Fish Protection Act*, a riparian area assessment report may be required before this application can be approved.

**Contaminated  
Sites Profile**

Pursuant to the *Environmental Management Act*, an applicant is required to submit a completed "Site Profile" for properties that are or were used for purposes indicated in Schedule 2 of the *Contaminated Sites Regulations*. Please indicate if:

yes ☐ no ☒

the property has been used for commercial or industrial purposes.

If you responded 'yes,' you may be required to submit a Site Profile. Please contact FVRD Planning or the Ministry of Environment for further information.

**Archaeological  
Resources**

Are there archaeological sites or resources on the subject property?

yes ☐ no ☒ I don't know ☐

If you responded 'yes' or 'I don't know' you may be advised to contact the Archaeology Branch of the Ministry of Tourism, Sport and the Arts for further information.



## Required Information

When providing Application Forms to the applicant, Regional District staff shall indicate which of the following attachments are required for this application. **Additional information may also be required at a later date.**

	Required	Received	Details
<b>Location Map</b>			Showing the parcel (s) to which this application pertains and uses on adjacent parcels
<b>Site Plan</b>			Reduced sets of metric plans
At a scale of:			North arrow and scale
1: _____			Dimensions of property lines, rights-of-ways, easements
			Location and dimensions of existing buildings & setbacks to lot lines, rights-of-ways, easements
			Location and dimensions of proposed buildings & setbacks to lot lines, rights-of-ways, easements
			Location of all water features, including streams, wetlands, ponds, ditches, lakes on or adjacent to the property
			Location of all existing & proposed water lines, wells, septic fields, sanitary sewer & storm drain, including sizes
			Location, numbering & dimensions of all vehicle and bicycle parking, disabled persons' parking, vehicle stops & loading
			Natural & finished grades of site, at buildings & retaining walls
			Location of existing & proposed access, pathways
			Above ground services, equipment and exterior lighting details
			Location & dimensions of free-standing signs
			Storm water management infrastructure and impermeable surfaces
			Other:
<b>Floor Plans</b>			Uses of spaces & building dimensions
			Other:
<b>Landscape Plan</b>			Location, quantity, size & species of existing & proposed plants, trees & turf
Same scale as site plan			Contour information (_____ metre contour intervals)
			Major topographical features (water course, rocks, etc.)
			All screening, paving, retaining walls & other details
			Traffic circulation (pedestrian, automobile, etc.)
			Other:
<b>Reports</b>			Geotechnical Report
			Environmental Assessment
			Archaeological Assessment
			Other:

The personal information on this form is being collected in accordance with Section 27 of the *Freedom of Information and Protection of Privacy Act, RSBC 1996 Ch. 165* and the *Local Government Act, RSBC 2015 Ch. 1*. It will only be collected, used and disclosed for the purpose of administering matters with respect to [planning](#), [land use management](#) and related [services delivered](#), or proposed to be delivered, by the FVRD. Questions about the use of personal information and the protection of privacy may be directed to the FVRD Privacy Officer at 45950 Cheam Avenue, Chilliwack, BC V2P 1N6, Tel: 1-800-528-0061 [FOI@fvr.ca](mailto:FOI@fvr.ca).

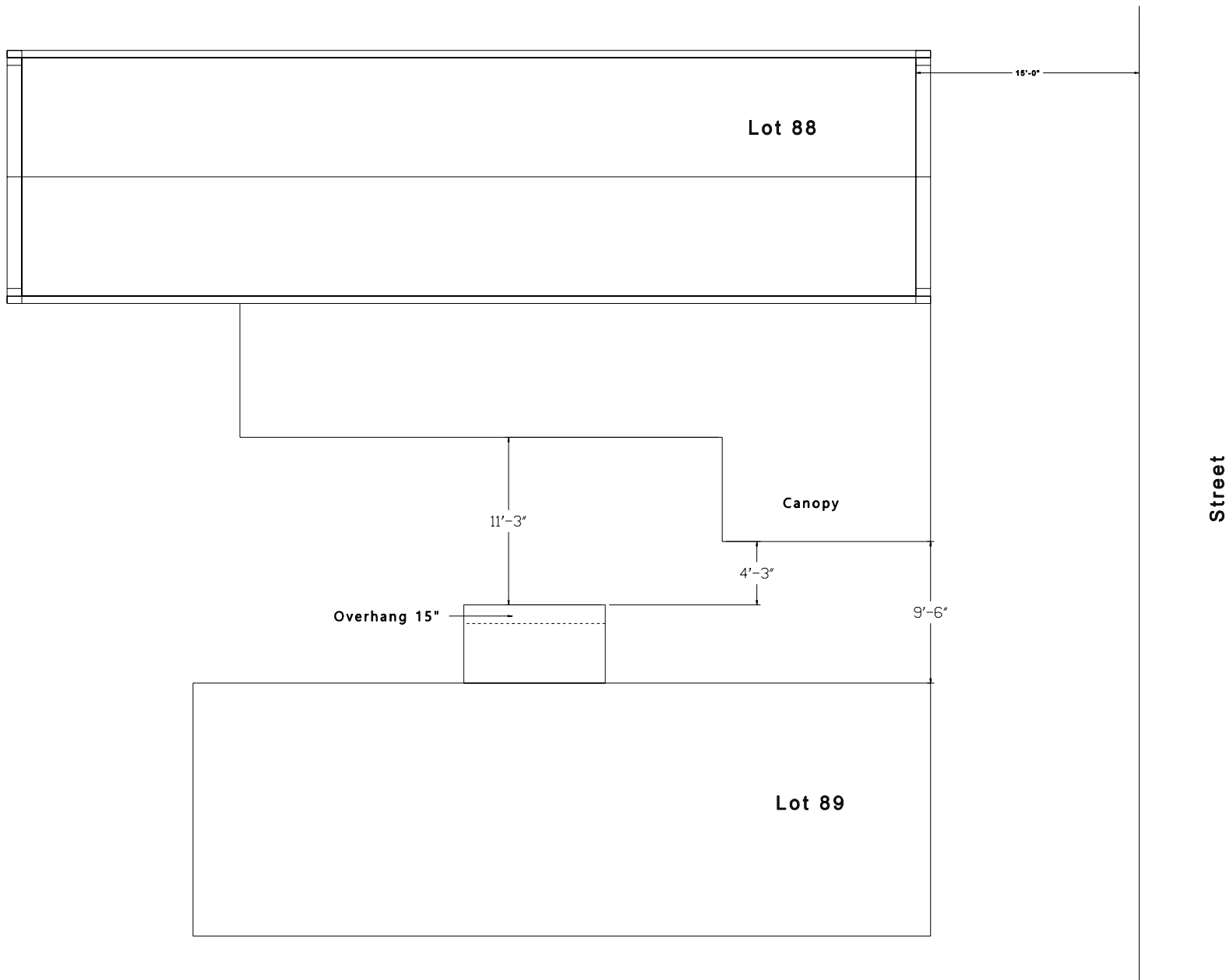

3942 Columbia Valley Road Cultus Lake, BC V0X 1H0	CUSTOMER:	Unit 88	DRAWING:	Lot Coverage	REVISIONS:	DRAWN BY:	PAGE NO:
		Bill Miller	SCALE:			DATE: 12/19/17	
						APPROVED BY:	